

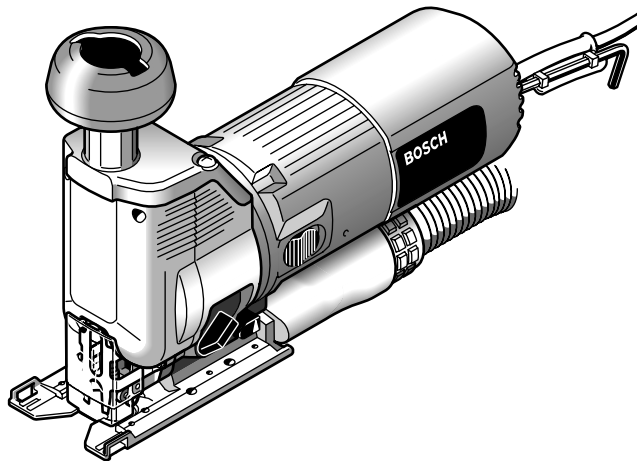

GST 85 P GST 85 PE GST 85 PAE PROFESSIONAL

BOSCH
Ideas that work.

* Des idées en action.

Bedienungsanleitung
Operating instructions
Instructions d'emploi
Instrucciones de servicio
Manual de instruções
Istruzioni d'uso
Gebruiksaanwijzing
Betjeningsvejledning
Bruksanvisning
Brukerveiledningen
Käyttöohje
Οδηγία χειρισμού
Kullanım kılavuzu







precision for Wood T 144 DP  $\pm 5-50\text{mm}$

speed for Wood T 144 D **fast CUT**  $\pm 5-50\text{mm}$

speed for Wood T 244 D **fast CUT**  $\pm 5-50\text{mm}$

clean for Wood T 101 B **clean CUT**  $\pm 3-30\text{mm}$ $< 30\text{mm}$

PROGRESSOR for Wood T 234 X **fast CUT**  $\pm 2-65\text{mm}$

PROGRESSOR for Wood and Metal T 345 XF **fast CUT**  $\pm 3-30\text{mm}$ $< 65\text{mm}$ $\pm 3-10\text{mm}$ $3-250\text{mm}$

basic for Metal T 118 A  $\pm 1-3\text{mm}$

PROGRESSOR for Metal T 123 X **fast CUT**  $\pm 1.5-10\text{mm}$ $< 30\text{mm}$

special for Alu T 127 D **fast CUT**  $< 30\text{mm}$ $< 30\text{mm}$

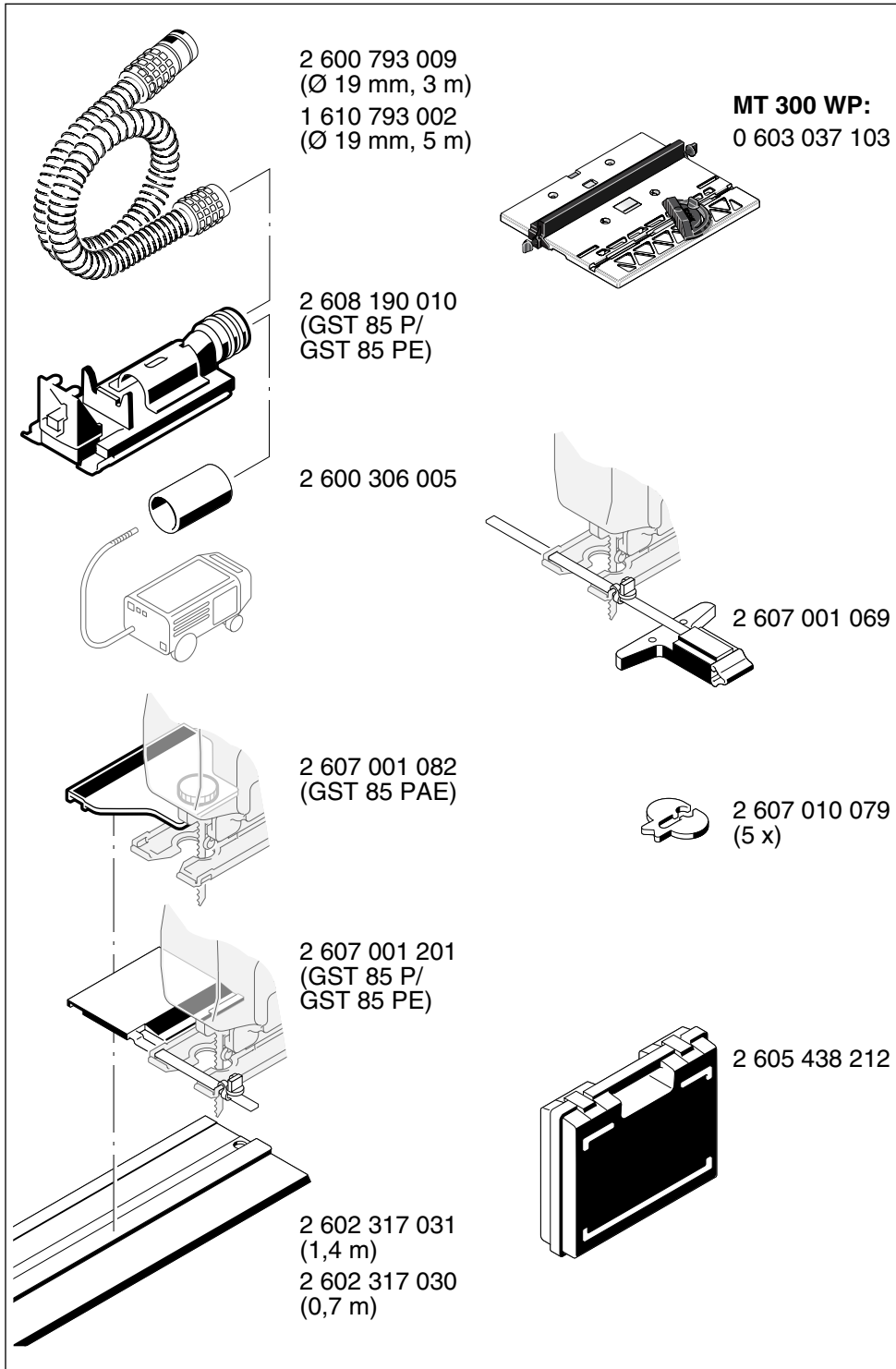

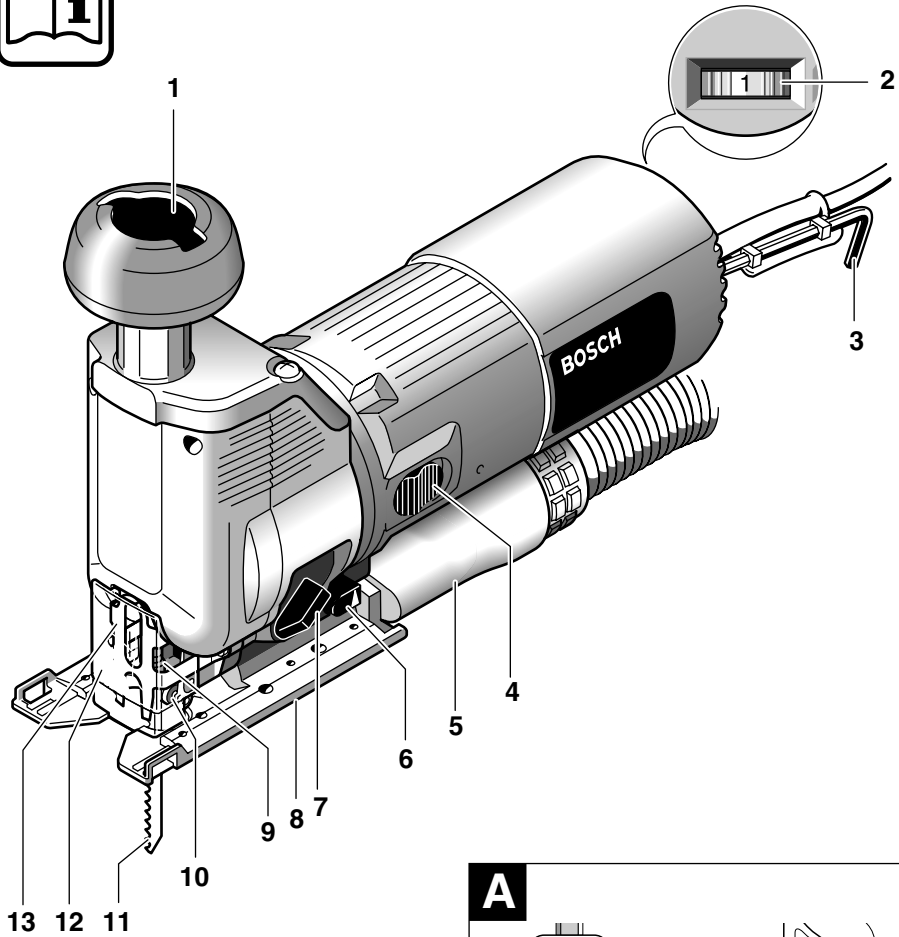

GST 85 PAE PROFESSIONAL

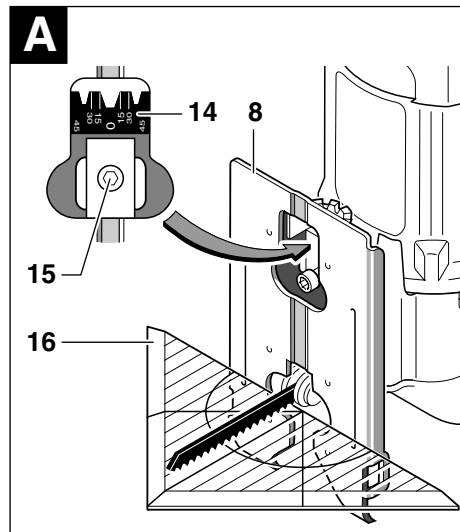

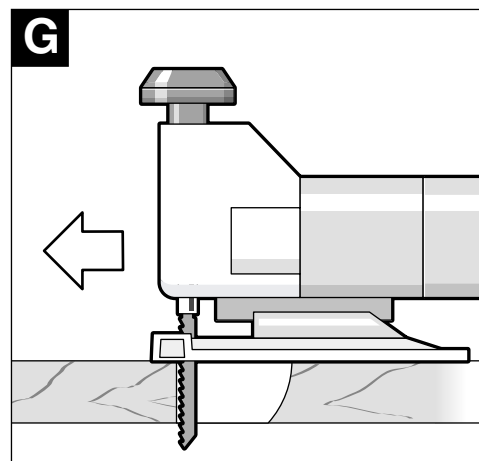
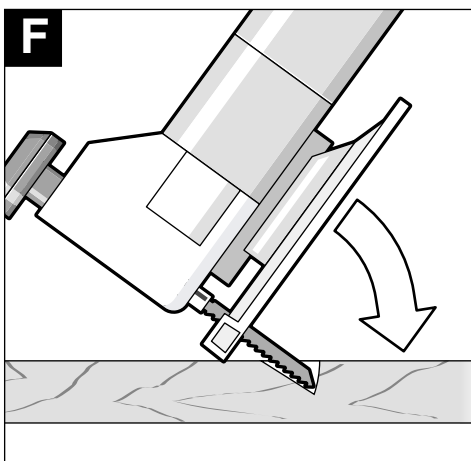
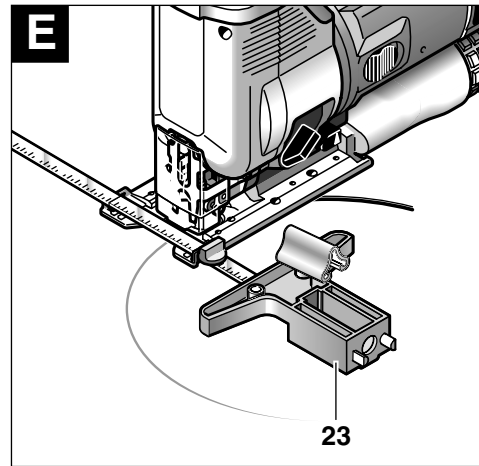
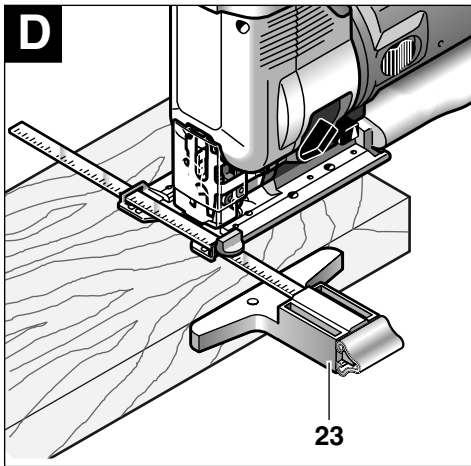
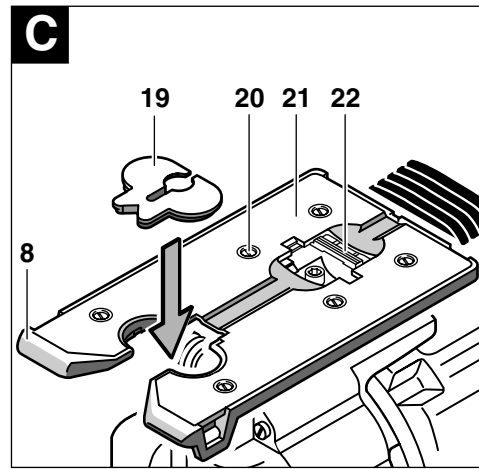
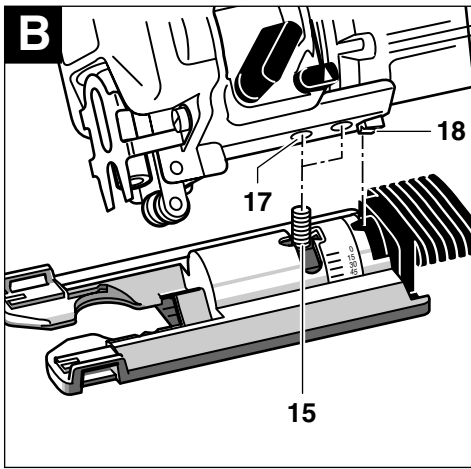

Tool Specifications

Jigsaw		GST 85 P PROFESSIONAL	GST 85 PE PROFESSIONAL
Article number		0 601 584 1..	0 601 584 6..
Jigsaw			GST 85 PAE PROFESSIONAL
Article number			0 601 584 8..
Rated input power	[W]	580	580
Output power	[W]	350	350
Stroke rate at no load	[spm]	3 100	500–3 100
Stroke	[mm]	26	26
Stroke rate preselection		–	●
Orbital action		●	●
Sawdust Blower Device		●	●
Cutting capacity, max.			
Wood	[mm]	85	85
Aluminium	[mm]	20	20
in non-alloy steel	[mm]	10	10
Bevel cuts (left/right)	[°]	0–45	0–45
Weight according to EPTA-Procedure 01/2003	[kg]	2.4	2.4
Protection class		□ / II	□ / II

Please observe the article number on the type plate of your machine. The trade names of the individual machines may vary.
The values given are valid for nominal voltages [U] of 230/240 V. For lower voltages and models for specific countries, these values can vary.

Machine Elements

The numbering of the machine elements refers to the illustration of the machine on the graphics page.

While reading the operating instructions, unfold the graphics page for the machine and leave it open.

- 1 Rotatable top handle with pushbutton
- 2 Stroke rate preselection thumbwheel (GST 85 PE/GST 85 PAE)
- 3 Allen key
- 4 On/Off switch
- 5 Vacuum connection (GST 85 PAE)
- 6 Switch for sawdust blowing device
- 7 Lever for adjustment of pendulum action
- 8 Base plate (GST 85 P/GST 85 PE)
- 8 Base plate with mit interior extraction channel (GST 85 PAE)
- 9 Stroke rod
- 10 Guide roller
- 11 Saw blade*
- 12 Cover guard (GST 85 PAE)
- 13 Contact protector

- 14 Scale for mitre angle
- 15 Screw
- 16 Angle gauge**
- 17 Thread
- 18 Positioning pin/markings
- 19 Splinter guard
- 20 Screw for replaceable base-plate cover (GST 85 PAE)
- 21 Replaceable base-plate cover (GST 85 PAE)
- 22 Slider (GST 85 PAE)
- 23 Circle cutter/parallel guide*

* Not all of the accessories illustrated or described are included as standard delivery.

**Commercially available (not included in the delivered items)

Intended Use

The machine is intended for making separating cuts and cut-outs in wood, plastic, metal, ceramic plates and rubber while resting firmly on the workpiece. It is suitable for straight and curved cuts with mitre angles to 45°. The saw blade recommendations are to be observed.

Noise/Vibration Information

Measured values determined according to EN 60 745.

Typically the A-weighted sound pressure level of the machine is 83 dB (A). Measurement uncertainty K=3 dB.

When working, the noise level can exceed 85 dB (A).

Wear hearing protection!

The typically weighted acceleration is 4 m/s².



For Your Safety

Read all instructions. Failure to follow all instructions listed below may result in electric shock, fire and/or serious injury.

Additionally, the general safety instructions either in the enclosed booklet or those added in the centre of these operating instructions must be observed.

SAVE THESE INSTRUCTIONS.

- **Secure the workpiece.** A workpiece clamped with clamping devices or in a vice is held more securely than by hand.
- **Take protective measures when dust can develop during working that is harmful to one's health, combustible or explosive.** Example: Some dusts are regarded as carcinogenic. Work with dust/chip extraction and wear a dust mask.
- **Keep your workplace clean.** Material mixtures are particularly dangerous. Dust of light metal can be inflammable or explode.
- **Do not work materials containing asbestos.** Asbestos is considered carcinogenic.
- **Always wait until the machine has come to a complete stop before placing it down.** The tool insert can jam and lead to loss of control over the power tool.
- **Do not use a machine with a damaged mains cable. Do not touch the damaged cable and pull the mains plug when the cable is damaged while working.** Damaged cables increase the risk of an electric shock.
- **Connect machines that are used in the open via a residual current device (RCD).**
- **Keep your hands away from the sawing range. Do not reach under the workpiece.** Contact with the saw blade can lead to injuries.

- **Guide the machine against the workpiece only when it is switched on.** Otherwise there may be danger of kickback when the tool insert jams in the workpiece.

- **Pay attention that the base plate 8 rest securely on the material while sawing.** A jammed saw blade can break or lead to kickback.

- **When the cut is completed, switch off the machine and then pull the saw blade out of the cut only after it has come to a standstill.** In this manner you can avoid kickback and can place down the machine securely.

- **Use only sharp, flawless saw blades.** Bent or unsharp saw blades can break or cause kickback.

- **Do not brake the saw blade to a stop by applying side pressure after switching off.** The saw blade can be damaged, break or lead to kickback.

- **Use suitable detectors to determine if utility lines are hidden in the work area or call the local utility company for assistance.**

Contact with electric lines can lead to fire and electric shock. Damaging a gas line can lead to explosion. Penetrating a water line causes property damage or may cause an electric shock.

- **Hold the power tool only by the insulated gripping surfaces when performing an operation where the cutting tool may contact hidden wiring or its own power cord.** Contact with a "live" wire will also make exposed metal parts of the power tool "live" and shock the operator.

Replacing/Inserting the Saw Blade

- Before any work on the machine itself, pull the mains plug.

Inserting the Saw Blade

- **Wear protective gloves when assembling the saw blade.** Contact with the saw blade can lead to injuries.

Before inserting the saw blade 11 set the adjusting lever for pendulum action 7 to level III.



Press down the orange pushbutton in the rotatable top handle 1 until it can be felt to engage.



Turn the rotatable top handle **1** approx. three rotations in counter-clockwise direction.

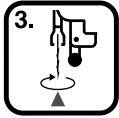

Insert the saw blade **11** in the stroke rod crosswise to the cutting direction. Turn the serrated edge of the saw blade to the cutting direction. Slightly lift the saw blade so that the back of the saw blade

comes to rest in the groove of the guide roller **10**. Allow it to notch by pulling slightly.



Turn the rotatable top handle **1** in clockwise direction until a snap is heard (click).



Afterwards, push up the orange pushbutton at the rotatable top handle **1** again to the starting position.

Starting Operation

Observe correct mains voltage: The voltage of the power source must agree with the voltage specified on the nameplate of the machine. Equipment marked with 230 V can also be connected to 220 V.

Switching On and Off

To **start** the machine, press the On/Off switch **4** forward.

To **switch** the machine **off**, press the On/Off switch **4** to the rear.

Stroke Rate Preselection (GST 85 PE/GST 85 PAE)

The required stroke rate can be preselected (also during operation) using the thumbwheel **2**.

1–2 = low stroke rate

3–4 = medium stroke rate

5–6 = high stroke rate

The required stroke rate is dependent on the material and the working conditions and can be determined by a practical trial.

After working for longer periods at low stroke rate allow the machine to cool down by running it at maximum stroke rate and no-load for approx. 3 minutes.

Contact Protector

The contact protector **13** attached to the housing prevents unintentional contact with the saw blade while working and should not be removed.

Sawdust Blower Device

The sawdust blower device leads an air jet to the saw blade. The air jet keeps sawdust from covering the cutting line during operation.

The air flow can be switched on or off with the switch for the sawdust blowing device **6**:



Sawdust blowing level I:

Low airstream, for cuts in metals and when coolants/lubricants are used.



Sawdust blowing level II:

Medium airstream, for cuts in materials with low chip removal rate, e. g. hardwood.

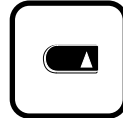

Sawdust blowing level III:

High airstream, for cuts in materials with high chip removal rate, e. g. soft wood, plastic, etc.

Pendulum Action Setting



The four pendulum action settings allow optimum adaptation of cutting speed, cutting capacity and cutting pattern to the material being sawed.

The pendulum action can be adjusted in four steps with the adjustment lever **7**. Switching is possible with the machine running:

Step 0: No pendulum action

Step I: Small pendulum action

Step II: Medium pendulum action

Step III: Large pendulum action

Recommendations:

- The more narrow and clean the cutting edge should be, the lower the pendulum action level should be selected (or switched off).
- For thin materials, e. g. sheet metal, switch the pendulum action off.
- For hard materials, e. g. steel, work with low pendulum action.
- For soft materials and when sawing in the direction of the grain, work with maximum pendulum action.

The optimal setting can be determined by practical testing.

Adjusting the Cutting Angle (see figure **A**)

GST 85 PAE: Remove the cover guard **12** and open the slider **22** at the bottom side of the base plate.

After loosening the screw **15** and sliding lightly forward in the direction of the saw blade, the base plate **8** can be swung to the right or left to a maximum of 45°.

After coarse adjustment, tighten the screw **15** so that the base plate **8** can still just be adjusted.

The cutting angle can be pre-adjusted by means of the scale for mitre angles **14**. Precise adjustment with use of a commercial angle gauge **16** is recommended.

Then tighten the screw **15** again.

To achieve precise cutting angles, the base plate is fitted with a locking device at 0° and 45° (left and right). For this, however, the base plate must be pushed back (towards the motor) to the stop, so that the notch in the base plate engages in the positioning pin **18**.

When returning the base plate to the 0° (normal) position, press the base plate lightly in the direction of the motor until it can be felt to engage and again tighten the screw **15**.

Offsetting the Base Plate (see figure **B**)

For sawing close to edges, the base plate can be offset to the rear:

GST 85 PAE: Remove the cover guard **12** and open the slider **22** at the bottom side of the base plate.

Use Allen key **3** to take out screw **15** completely.

Lift the base plate and move it to the rear such that the screw can be turned into the rear thread.

When tightening the screw **15**, the base plate must be pressed to the rear until it can be felt to engage.

- With the base plate offset, only the 0° (normal) position can be used.
- The circle cutter/parallel guide **23** as well as the splinter guard **19** cannot be used in this case.

Replaceable Base-plate Covers (GST 85 PAE – see figure **C**)

The base plate **8** is originally equipped with a replaceable base-plate cover **21** made of plastic. It ensures good sliding capability on wood and plastic surfaces, and largely avoids scratching of sensitive surfaces.

After loosening the six screws **20**, the replaceable plastic base-plate cover can be exchanged against a steel insert, which is intended for use on metal surfaces.

Splinter Guard (see figure **C**)

To avoid fraying of the surface, install the splinter guard **19** by pressing it into the base plate **8**.

The splinter guard cannot be used for certain saw blade types (e. g., saw blades with set teeth).

Dust/Chip Extraction (GST 85 PAE)

The machine can be plugged directly into the receptacle of a Bosch all-purpose vacuum cleaner with remote starting control. The vacuum cleaner starts automatically when the machine is switched on.

The vacuum cleaner must be suitable for the material to be worked.

When vacuuming dry dust that is especially detrimental to health or carcinogenic, use a special vacuum cleaner.

For external dust extraction with a vacuum cleaner, an extraction adapter must be used as required (see accessories). Insert extraction adapter and vacuum connection firmly.

Attach the vacuum connection **5** to the base plate **8** and connect the extraction hose.

For low blowing effect, set the sawdust blower switch **6** upward.

Cover Guard

The transparent cover guard **12** enables the collection of chips and sawdust. To achieve optimum results, it must always be mounted when working with dust extraction.

Tips

For tight curves it is best to use a narrow saw blade.

When sawing metal or similar materials, apply coolant/lubricant alongside the cutting line.

Circle Cutter/Parallel Guide (Accessory – see figures **D** – **E**)

With the combined circle cutter/parallel guide **23**, circular cutouts or parallel cuts in materials of up to 30 mm thickness can be made.

Plunge Cutting (see figures **F** – **G**)

Plunge cuts may only be applied to soft materials, such as wood, aerated concrete, gypsum plaster boards, etc.!

Place the machine with the front edge of the base plate on to the workpiece and switch on. Firmly hold the machine against the workpiece and by tilting the machine, slowly plunge the saw blade into the workpiece.

When the base plate fully lays on the surface, continue sawing along the cutting line.

Removing the Rotatable Top Handle

For easier sawing in particularly tight locations, the rotatable top handle **1** can be removed. For this, press the orange pushbutton beyond the latching point and pull off the rotatable top handle upward at the same time.

Before assembling the rotatable top handle **1**, push up the orange pushbutton back into the starting position again. Attach the rotatable top handle **1** and press downward until it can be felt to engage.

Maintenance and Cleaning

- Before any work on the machine itself, pull the mains plug.
- For safe and proper working, always keep the machine and its ventilation slots clean.
- In order to avoid operational malfunctions, do not saw gypsum board from below or overhead.



In extreme working conditions, conductive dust can accumulate in the interior of the machine when working with metal. The protective insulation of the machine can be degraded. The use of a stationary extraction system is recommended in such cases as well as frequently blowing out the ventilation slots and installing a residual current device (RCD).

The guide roller **10** should occasionally be checked for wear and lubricated with a drop of oil. If it is worn, it must be replaced.

If the machine should fail despite the care taken in manufacturing and testing procedures, repair should be carried out by an authorized after-sales service centre for Bosch power tools.

In all correspondence and spare parts orders, please always include the 10-digit article number given on the nameplate of the machine.

WARNING! Important instructions for connecting a new 3-pin plug to the 2-wire cable.

The wires in the cable are coloured according to the following code:

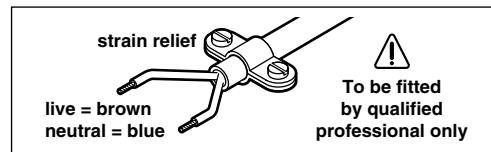

Do **not** connect the blue or brown wire to the earth terminal of the plug.

Important: If for any reason the moulded plug is removed from the cable of this machine, it must be disposed of safely.

Environmental Protection



Recycle raw materials instead of disposing as waste

The machine, accessories and packaging should be sorted for environmental-friendly recycling.

These instructions are printed on recycled paper manufactured without chlorine.

The plastic components are labelled for categorised recycling.

Service and Customer Assistance

Exploded views and information on spare parts can be found under:
www.bosch-pt.com

Great Britain

Robert Bosch Ltd. (B.S.C.)
P.O. Box 98
Broadwater Park
North Orbital Road
Denham-Uxbridge
Middlesex UB 9 5HJ

☎ Service +44 (0) 18 95 / 83 87 82
☎ Advice line +44 (0) 18 95 / 83 87 91
Fax +44 (0) 18 95 / 83 87 89

Ireland

Beaver Distribution Ltd.
Greenhills Road
Tallaght-Dublin 24

☎ Service +353 (0)1 / 414 9400
Fax +353 (0)1 / 459 8030

Australia and New Zealand

Robert Bosch Australia Pty. Ltd.
RBAU/SPT
1555 Centre Road
P.O. Box 66
3168 Clayton/Victoria

☎ +61 (0)1 / 3 00 30 70 44

Fax +61 (0)1 / 3 00 30 70 45

www.bosch.com.au

CE Declaration of Conformity

We declare under our sole responsibility that this product is in conformity with the following standards or standardization documents: EN 60 745 according to the provisions of the directives 89/336/EEC, 98/37/EC.

Dr. Egbert Schneider
Senior Vice President
Engineering

Dr. Eckerhard Strötgen
Head of Product
Certification

Robert Bosch GmbH, Geschäftsbereich Elektrowerkzeuge

Subject to change without notice



* Des idées en action.

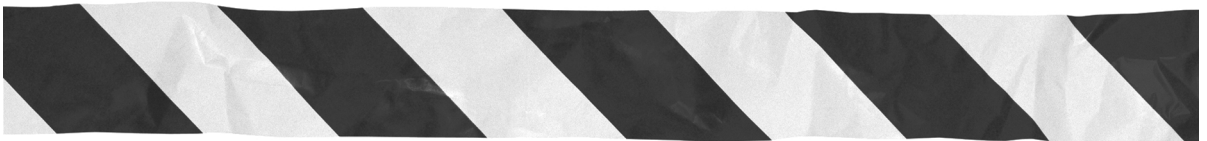
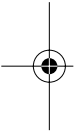

Robert Bosch GmbH
Geschäftsbereich Elektrowerkzeuge
70745 Leinfelden-Echterdingen
www.bosch-pt.com

2 609 931 878 (04.11) O / 81
Printed in PRC

